

SP SERIES

海雄SP系列注塑机



- 优化设计的塑化部件, 使机器的塑化能力、注射精度显著提升; 螺杆传动采用花键联接, 螺杆旋转时受力均匀; 射移部分采用直线导轨导向, 降低运动时的摩擦力。

The plasticizing parts with optimized design can improve the plasticizing ability and injection precision of the machine significantly; Screw transmission adopts the spline to connect and the force is uniform when the screw rotates, The moving part is guided by linear guide rail to reduce friction during movement.

- 优化设计的五支点内卷式锁模部件, 具有压中心的模板结构, 既使锁模力直接作用于模具上, 又避免了外翻式结构在遇到长偏心模具时模板会产生倾斜的弊端, 提高了制品的成型精度; 具有更大的移模行程和较低的销轴接触应力。

The clamping parts with optimized design has a mold-plate structure with a pressing center, which makes the clamping force act on the moldplate directly and improves the forming accuracy of the product. And it has a larger moving mold-plate stroke as well as reduces the contact stress of the axis pin.

- 侧置式新型机械保险结构; 斜楔式动模板滑脚结构。

Newly designed lateral mechanical safety structure; The feet slip structure of moving mold-plate is newly designed with oblique-wedge.

- 采用精密控制系统, 机器运行稳定可靠, 重复精度高, 抗干扰性强, 安全保护级别高。具有能耗监测功能。

Adopt high-precision controller system, provide performance more stable, higher repetition precision, stronger anti-interference and higher level of security protection. Also standard with fuction of energyconsumption monitoring.

- 全新设计的五支点曲肘机构的运动曲线显示, 动模板的运动具有速度更快更平稳、可控性更好的优点, 使机器具有更短的干循环周期。

The movement curve of newly designed five-points double toggle structure shows that the movemen of movable mould-plate has advantages of being faster, more stable and better controllability, And also quicker cycle.

- 液压动力系统使用高响应、大扭矩、低惯量、低噪音的电机, 配合改良后的螺杆泵, 给客户带来无与伦比的高性能和低噪音感受, 并在低压模具保护和振动脱模上有更加突出的表现。

Hydraulic power system uses the motors with high response, high power density, low inertia and low noise to bring unique feeling of high performance and low noise to customers with improved screw pump.

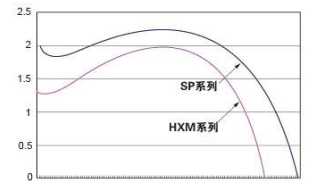

产品规格	SPECIFICATIONS	UNIT	SP100 / i180			SP100 / i390			SP130 / i520			SP160 / i650		
注射装置	INJECTION UNIT		A	B	C	A	B	C	A	B	C	A	B	C
螺杆直径	Screw diameter	mm	22	25	28	32	36	40	36	40	45	40	45	50
螺杆长径比	Screw L/D ratio	L/D	22	22	22	23.6	21	21	23.3	21	21	22.5	20	20
理论注射容积	Injection capacity in theory	cm ³	49	63	80	144	183	226	203	251	318	282	357	441
注射重量	Injection weight(ps)	g	44	58	72	131	167	206	185	228	289	257	325	402
注射压力	Injection pressure	MPa	349	270	215	239	189	153	230	186	147	234	185	150
注射速率	Injection velocity	g/s	65	84	105	102	129	159	132	163	207	163	207	256
塑化能力	Plasticizing capacity	g/s	4	6	9	10	14	19	15	22	29	14	20	26
螺杆转速	Screw speed	rpm	300			300			300			240		
合模装置	CLAMPING UNIT													
合模力	Clamping force	kN	1000			1000			1300			1600		
移动模板行程	Moving mould-plate stroke	mm	360			360			410			470		
最大模厚	Max.Mould height	mm	400			400			460			550		
最小模厚	Min.Mould height	mm	150			150			150			180		
拉杆有效间距	Space between tie-bars	mm	360×360			360×360			420×420			470×470		
液压顶出力	Hydraulic ejector force	kN	49			49			49			67		
液压顶出行程	Hydraulic ejector stroke	mm	120			120			120			150		
顶出点数	Ejector number	n	5			5			5			5		
其它	OTHER													
油泵压力	Pump pressure	MPa	17.5			17.5			17.5			17.5		
电机功率	Motor power	kW	16			16			21			30		
加热功率	Heating capacity	kW	7			10.5			10.95			12.95		
外形尺寸	Machine dimension	m	4.16×1.18×1.78			4.45×1.16×1.98			4.87×1.25×2.00			5.39×1.40×2.07		
机器重量	Machine weight	t	3.1			3.3			4			5.1		
油箱容积	Oil tank capacity	L	235			235			253			270		

模板正面尺寸
Platen Dimensions(frontal)

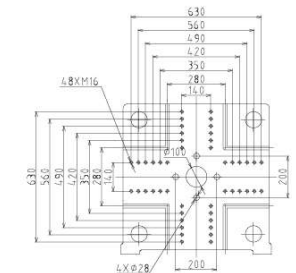
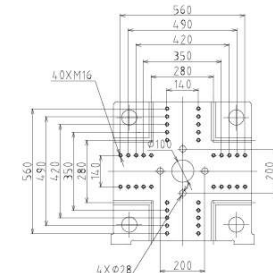
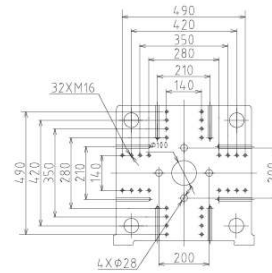
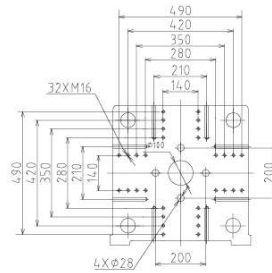

模板侧面尺寸
Platen Dimensions(flank)

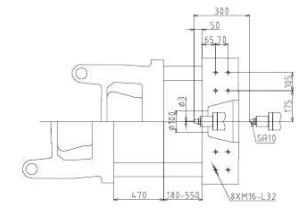
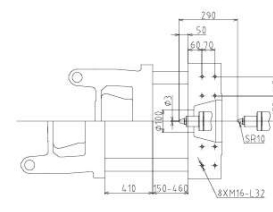
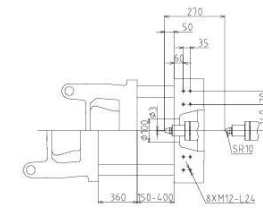
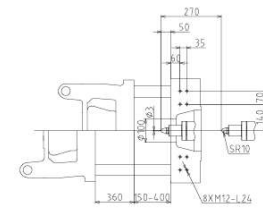

产品技术参数更改,恕不另行通知 Due to continual improvement,specifications are subject to change without notification

产品规格	SPECIFICATIONS	UNIT	SP200 / i810			SP260 / i1000			SP300 / i1620			SP350/ i2300			
注射装置	INJECTION UNIT		A	B	C	A	B	C	A	B	C	A	B	C	D
螺杆直径	Screw diameter	mm	45	50	55	50	55	60	55	60	65	60	65	70	75
螺杆长径比	Screw L/D ratio	L/D	22.2	20	20	22	20	20	21.8	20	20	21.6	20	20	18.6
理论注射容积	Injection capacity in theory	cm ³	357	441	534	490	593	706	688	819	962	989	1161	1346	1546
注射重量	Injection weight(ps)	g	325	402	486	446	540	643	626	746	875	900	1056	1225	1407
注射压力	Injection pressure	MPa	229	186	153	236	194	163	239	201	171	233	198	171	149
注射速率	Injection velocity	g/s	199	245	297	233	282	336	254	303	355	312	367	425	488
塑化能力	Plasticizing capacity	g/s	22	28	35	28	37	44	33	41	49	35	43	52	62
螺杆转速	Screw speed	rpm	240			240			210			200			
合模装置	CLAMPING UNIT														
合模力	Clamping force	kN	2000			2600			3000			3500			
移动模板行程	Moving mould-plate stroke	mm	540			580			650			750			
最大模厚	Max.Mould height	mm	600			650			700			750			
最小模厚	Min.Mould height	mm	200			250			250			280			
拉杆有效间距	Space between tie-bars	mm	530×530			580×580			630×630			720×720			
液压顶出力	Hydraulic ejector force	kN	67			87			110			130			
液压顶出行程	Hydraulic ejector stroke	mm	150			160			160			180			
顶出点数	Ejector number	n	9			13			13			13			
其它	OTHER														
油泵压力	Pump pressure	MPa	17.5			17.5			17.5			17.5			
电机功率	Motor power	kW	30			38			38			47			
加热功率	Heating capacity	kW	13.55			16.83			18.15			23			
外形尺寸	Machine dimension	m	5.81×1.45×2.18			6.04×1.60×2.28			6.39×1.62×2.29			7.40×1.9×2.40			
机器重量	Machine weight	t	7.4			9			10			14.5			
油箱容积	Oil tank capacity	L	280			300			400			680			

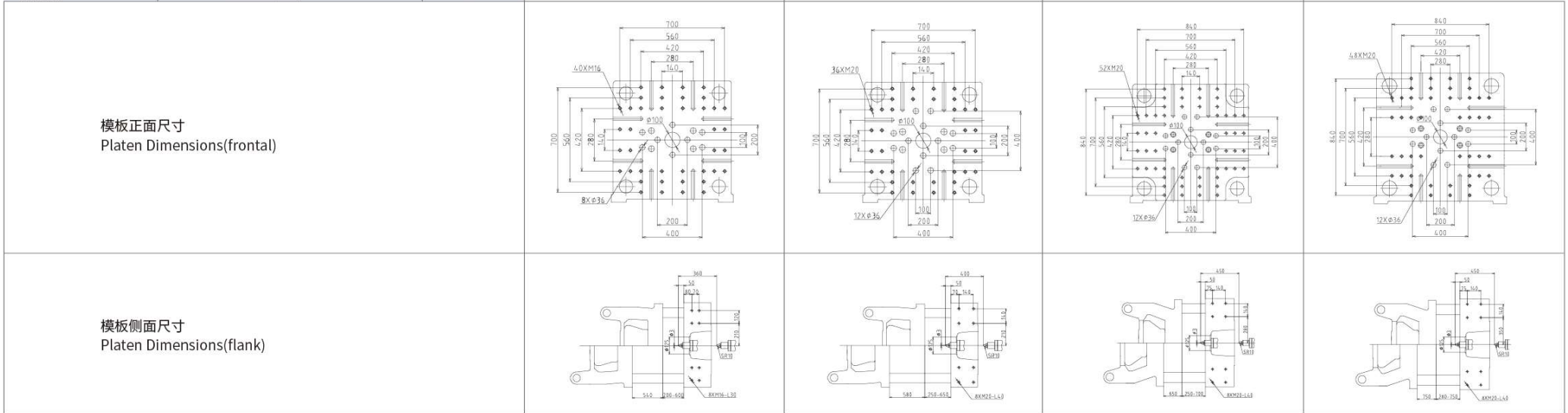

产品技术参数更改,恕不另行通知 Due to continual improvement,specifications are subject to change without notification

产品规格	SPECIFICATIONS	UNIT	SP160PET	SP200PET	SP260PET
注射装置	INJECTION UNIT				
螺杆直径	Screw diameter	mm	60	65	70
螺杆长径比	Screw L/D ratio	L/D	24	24	24
理论注射容积	Injection capacity in theory	cm ³	706	962	1232
注射重量	Injection weight(ps)	g	820	1115	1429
注射压力	Injection pressure	MPa	163	171	176
注射速率	Injection velocity	g/s	374	413	396
塑化能力	Plasticizing capacity	g/s	49	55	66
螺杆转速	Screw speed	rpm	170	160	160
合模装置	CLAMPING UNIT				
合模力	Clamping force	kN	1600	2000	2600
移动模板行程	Moving mould-plate stroke	mm	470	540	580
最大模厚	Max.Mould height	mm	550	600	650
最小模厚	Min.Mould height	mm	180	200	250
拉杆有效间距	Space between tie-bars	mm	470×470	530×530	580×580
液压顶出力	Hydraulic ejector force	kN	87	99	99
液压顶出行程	Hydraulic ejector stroke	mm	150	150	160
顶出点数	Ejector number	n	5	9	13
其它	OTHER				
油泵压力	Pump pressure	MPa	17.5	17.5	17.5
电机功率	Motor power	kW	38	38	38
加热功率	Heating capacity	kW	21	23	23
外形尺寸	Machine dimension	m	5.06×1.25×1.98	5.39×1.34×2.13	5.8×1.65×2.23
机器重量	Machine weight	t	5.2	7.6	9
油箱容积	Oil tank capacity	L	270	280	300
模板正面尺寸 Platen Dimensions(frontal)					
模板侧面尺寸 Platen Dimensions(flank)					

产品技术参数更改,恕不另行通知 Due to continual improvement,specifications are subject to change without notification

产品规格	SPECIFICATIONS	UNIT	SP300PET	SP350PET	SP420PET	SP480PET
注射装置	INJECTION UNIT					
螺杆直径	Screw diameter	mm	75	85	95	100
螺杆长径比	Screw L/D ratio	L/D	24	24	24	24
理论注射容积	Injection capacity in theory	cm ³	1502	2099	2622	3298
注射重量	Injection weight(ps)	g	1742	2434	3042	3825
注射压力	Injection pressure	MPa	149	147	130	134
注射速率	Injection velocity	g/s	520	727	895	1012
塑化能力	Plasticizing capacity	g/s	54	90	95	100
螺杆转速	Screw speed	rpm	130	130	110	110
合模装置	CLAMPING UNIT					
合模力	Clamping force	kN	3000	3500	4200	4800
移动模板行程	Moving mould-plate stroke	mm	650	750	770	830
最大模厚	Max.Mould height	mm	700	750	800	820
最小模厚	Min.Mould height	mm	250	280	280	300
拉杆有效间距	Space between tie-bars	mm	630×630	720×720	770×740	820×800
液压顶出力	Hydraulic ejector force	kN	111	193	193	193
液压顶出行程	Hydraulic ejector stroke	mm	160	180	210	210
顶出点数	Ejector number	n	13	13	13	13
其它	OTHER					
油泵压力	Pump pressure	MPa	17.5	17.5	17.5	17.5
电机功率	Motor power	kW	47	30+30	30+30	30+37
加热功率	Heating capacity	kW	24.7	31.1	34	48
外形尺寸	Machine dimension	m	6.5×1.75×2.8	7.4×1.9×2.8	7.57×1.9×2.83	7.85×1.8×2.87
机器重量	Machine weight	t	10	14.5	15	18.5
油箱容积	Oil tank capacity	L	400	680	680	900

模板正面尺寸
Platen Dimensions(frontal)

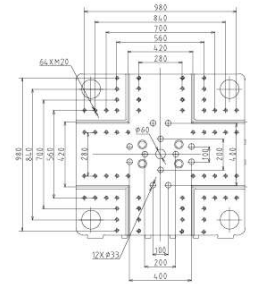
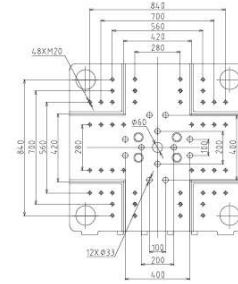
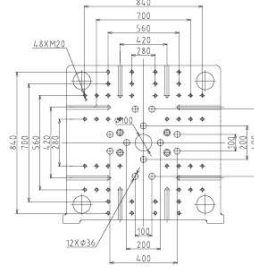
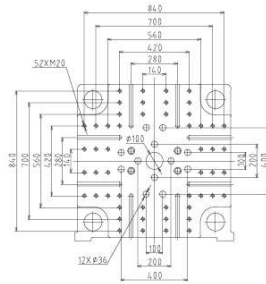

模板侧面尺寸
Platen Dimensions(flank)

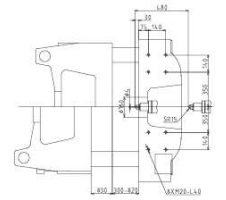
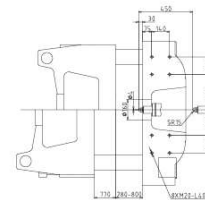
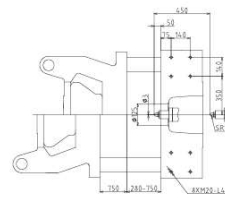
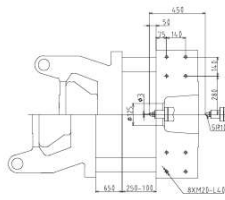

产品技术参数更改,恕不另行通知 Due to continual improvement,specifications are subject to change without notification

产品规格	SPECIFICATIONS	UNIT	SP160PVC	SP200PVC	SP260PVC	SP300PVC
注射装置						
INJECTION UNIT						
螺杆直径	Screw diameter	mm	50	55	60	65
螺杆长径比	Screw L/D ratio	L/D	20	20	20	20
理论注射容积	Injection capacity in theory	cm ³	441	534	706	962
注射重量	Injection weight(ps)	g	530	640	847	1154
注射压力	Injection pressure	MPa	166	169	163	171
注射速率	Injection velocity	g/s	271	247	363	427
塑化能力	Plasticizing capacity	g/s	31	40	50	59
螺杆转速	Screw speed	rpm	210	210	210	210
合模装置						
CLAMPING UNIT						
合模力	Clamping force	kN	1600	2000	2600	3000
移动模板行程	Moving mould-plate stroke	mm	470	540	580	650
最大模厚	Max.Mould height	mm	550	600	650	700
最小模厚	Min.Mould height	mm	180	200	250	250
拉杆有效间距	Space between tie-bars	mm	470×470	530×530	580×580	630×630
液压顶出力	Hydraulic ejector force	kN	67	67	87	87
液压顶出行程	Hydraulic ejector stroke	mm	150	150	160	160
顶出点数	Ejector number	n	5	9	13	13
其它						
OTHER						
油泵压力	Pump pressure	MPa	17.5	17.5	17.5	17.5
电机功率	Motor power	kW	30	30	38	38
加热功率	Heating capacity	kW	12.95	13.55	16.83	18.15
外形尺寸	Machine dimension	m	5.06×1.2×1.98	5.39×1.34×2.13	5.8×1.65×2.23	6.5×1.75×2.8
机器重量	Machine weight	t	5.2	7.6	8.8	9.6
油箱容积	Oil tank capacity	L	270	280	300	400

模板正面尺寸
Platen Dimensions(frontal)

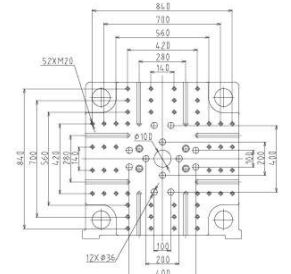
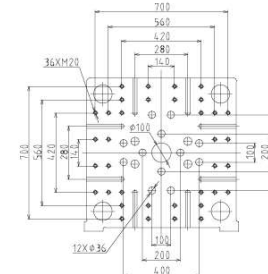
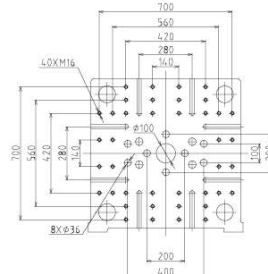
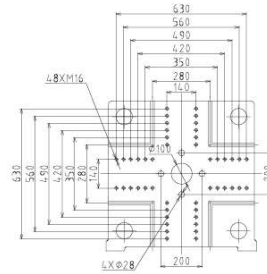

模板侧面尺寸
Platen Dimensions(flanck)

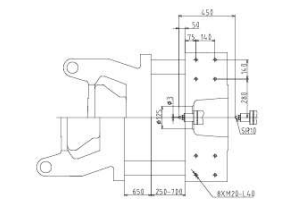
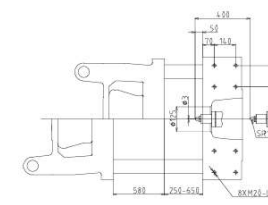
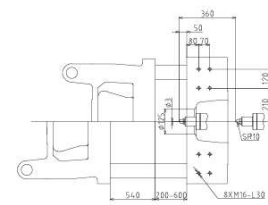
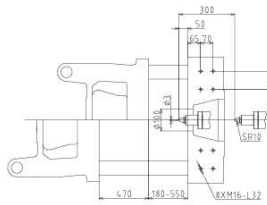

产品技术参数更改,恕不另行通知 Due to continual improvement,specifications are subject to change without notification

产品规格	SPECIFICATIONS	UNIT	SP350PVC	SP420PVC	SP480PVC	SP550PVC	SP650PVC
注射装置	INJECTION UNIT						
螺杆直径	Screw diameter	mm	70	80	85	90	95
螺杆长径比	Screw L/D ratio	L/D	20	20	20	20	20
理论注射容积	Injection capacity in theory	cm ³	1346	1860	2099	2671	3118
注射重量	Injection weight(ps)	g	1615	2232	2518	3205	3741
注射压力	Injection pressure	MPa	171	166	162	162	177
注射速率	Injection velocity	g/s	469	656	740	840	891
塑化能力	Plasticizing capacity	g/s	57	78	90	99	109
螺杆转速	Screw speed	rpm	160	160	150	150	145
合模装置	CLAMPING UNIT						
合模力	Clamping force	kN	3500	4200	4800	5500	6500
移动模板行程	Moving mould-plate stroke	mm	750	770	830	870	970
最大模厚	Max.Mould height	mm	750	800	820	830	950
最小模厚	Min.Mould height	mm	280	280	300	330	350
拉杆有效间距	Space between tie-bars	mm	720×720	770×740	820×800	870×840	970×920
液压顶出力	Hydraulic ejector force	kN	130	134	134	193	227
液压顶出行程	Hydraulic ejector stroke	mm	180	210	210	230	260
顶出点数	Ejector number	n	13	13	13	17	17
其它	OTHER						
油泵压力	Pump pressure	MPa	17.5	17.5	17.5	17.5	17.5
电机功率	Motor power	kW	47	30+30	30+30	30+40	40+40
加热功率	Heating capacity	kW	23	26	26	28	42
外形尺寸	Machine dimension	m	7.4×1.90×2.8	7.57×1.96×2.83	7.85×1.89×2.87	8.1×2.14×2.92	9.22×2.27×2.98
机器重量	Machine wight	t	14.5	14.5	16.5	20.5	29
油箱容积	Oil tank capacity	L	680	680	900	969	1156
模板正面尺寸 Platen Dimensions(frontal)							
模板侧面尺寸 Platen Dimensions(flank)							

产品技术参数更改,恕不另行通知 Due to continual improvement,specifications are subject to change without notification